

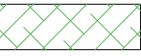

- R - STREFA REKREACJI
- P - PARKING
- S - ALTANA ŚMIETNIKOWA
- C - PRZYGOTOWANIE CIEPŁA
- W - WJAZD NA TEREN
- G - WJAZD DO GARAZU

-  - OGRÓDKI MIESZKAŃ
-  - ZIELEŃ
-  - WEJŚCIA
-  - WEJŚCIE NA TEREN

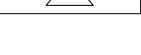
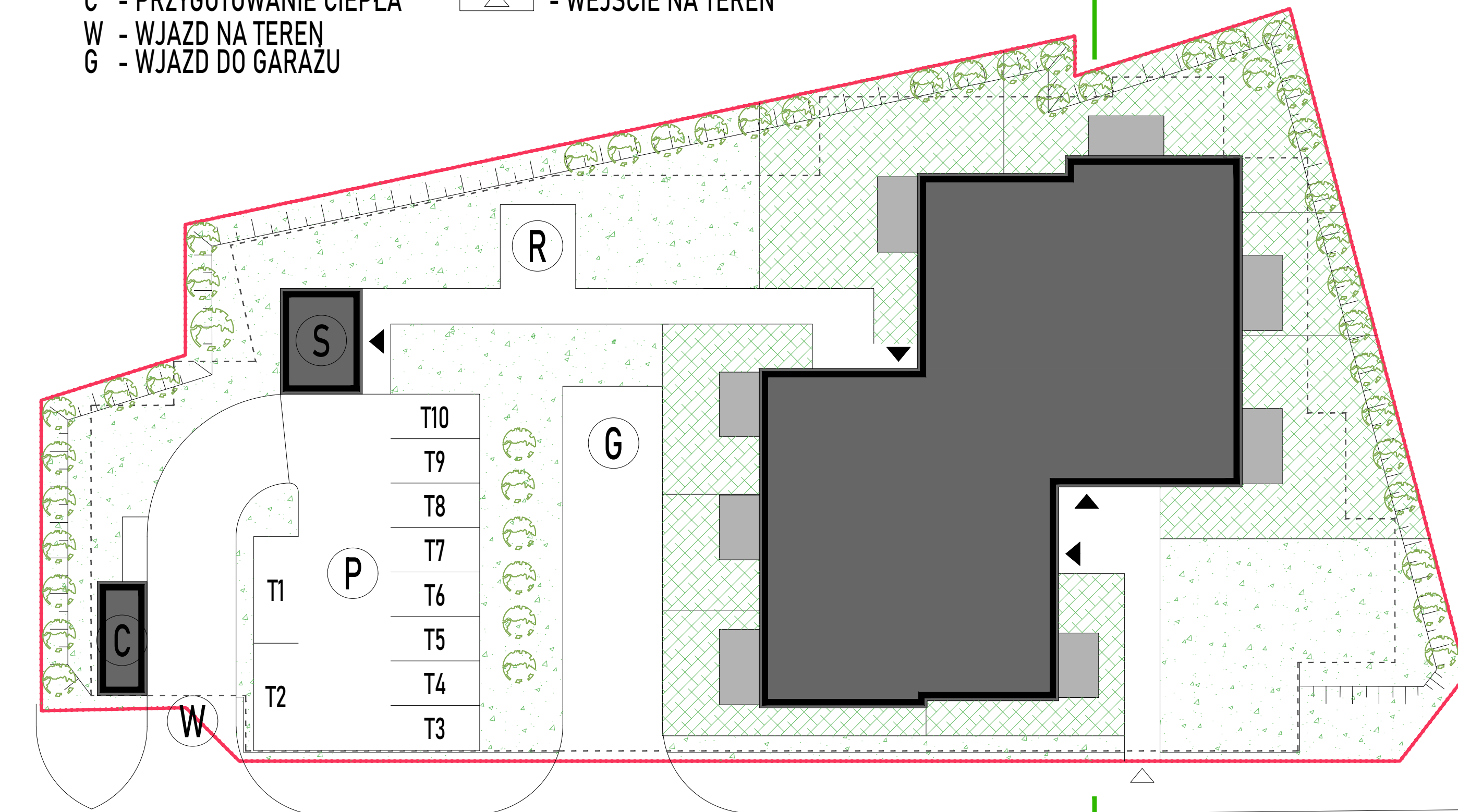

Rzepichy 3, Warszawa